

Lot 104, Discover Marong Stage 4 Marong

Site Classification for
Arbor Estates

Report 18C 0868 (Lot 104)
November 2018

Lot 104, Discover Marong Stage 4 Marong

Site Classification for Arbor Estates

Revision

Revision	Date	Authorised
18C 0868 (Lot 104)	9/11/18	SEH

Distribution (this revision only)

Recipient	Format	Date
GTSS	On file	9/11/18
Arbor Estates	Email PDF	9/11/18

1 INTRODUCTION

Arbor Estates commissioned Geotechnical Testing Services to conduct a geotechnical investigation for the proposed development located at Lot 104, Discover Marong Stage 4, Marong.

The investigation has been conducted for the purpose of assessing general subsurface conditions at the site and consequently assigning a Site Classification in accordance with *AS2870 – 2011 Residential Slabs and Footings*.

2 INVESTIGATION

The investigation was conducted by a technician on the 26th October 2018 using a trailer mounted drill-rig and drilling 2 boreholes to depths of 1.5 to 3.0 metres within the designated area. The subsequent soil profiles are presented in page 6 and the location of the boreholes are presented on page 7.

At the time of this investigation, the type of development proposed is unknown to GTS.

3 SITE CONDITIONS

The site is relatively flat and is currently vacant. At the time of the investigation the surface of the site was dry with no grass cover. There are no trees present in the immediate vicinity. There was visual evidence of surface cracking but no evidence of surface rock. No groundwater seepage was encountered over the investigated depths.

Full details of soil conditions are presented in the borehole logs.

4 SITE CLASSIFICATION

After allowing due consideration to the site geology, soil conditions, drainage and known details of the proposed development, the site has been classified as **Class H1-D** (AS2870 – 2011).

Foundations designed in accordance with this classification are to be subject to the overriding conditions of Section 5 below.

5 DISCUSSION

Particular attention should be paid to the design of footings as required by *AS2870 – 2011*.

In addition to the normal founding requirements arising from the above classification, particular conditions at the site dictate that the founding medium and minimum depth below existing surface levels for all footings should be as follows:

- Silty CLAY, high plasticity, pale brown to brown, very stiff, traces of fine gravel
At depth below 0.1 metres

An allowable bearing pressure of 100kPa is available for edge beams, strips and stump footings founded as above. All foundations should extend a minimum of 100mm into the above founding material.

The proposed dwelling should be located a minimum distance of 1 x the mature height of all trees. This distance can be increased by 50 % for groups or lines of trees. If this distance is impeded then the size and distance from the dwelling of the tree(s) needs to be taken into account when designing the foundation.

6 IMPORTANT NOTES ABOUT THIS REPORT

- The site classification presented in Section 4 assumes that the current natural drainage and infiltration conditions at the site will not be markedly affected by the proposed site development work. Care should therefore be taken to ensure that surface water is not permitted to collect adjacent to the structure and that significant changes to seasonal soil moisture equilibria do not develop as a result of service trench construction or tree root action.
- Attention is drawn to Appendix B of *AS2870* and CSIRO document, *BTF 18 – Foundation Maintenance and Footing Performance: A Homeowner's Guide* as a guide to maintenance requirement for the proposed structure.
- This is not a comprehensive investigation nor is it economic or practical to determine every subsurface feature on the site. Although this investigation indicates that soil conditions are relatively uniform across the site, it is recommended that the base of all footing excavations be inspected to ensure that the founding medium meets that requirements referenced herein with respect to type and strength of founding materials. If further variations in descriptions in soil types, colour or depths are discovered during construction, this office should be notified immediately so that potential influence on the footings may be assessed.
- The soil colours provided in the borehole logs attached may vary with soil moisture content and individual interpretation, therefore colour alone should not be used to identify these soils.

- Strength characteristics of soils often exhibit a large variation between wet and dry conditions. Soil characteristics of a soil profile are given on the soil conditions at the time of the investigation.
- In the event of significant earthworks being undertaken on the site after this investigation, this report may require an amendment if appropriate.
- If FILL is found during this investigation, it is an indication of what was found during the investigation and it may vary over the site. It may be in the best interest of the buyer / seller to undertake a more detailed investigation, in this instance.

Should you have any further queries concerning these results, please do not hesitate in contacting this office on 5441 4881.

Prepared by:



Benj Beatty BA/BSc (Hons), MPA
Geotechnical Engineer

Reviewed by:



Shane Hampton BE (Hons)
Senior Geotechnical Engineer

Enclosed

Borehole Logs (Page 6)
Site Map (Page 7)

Borehole Logs

Client:	Arbor Estates	Borehole Log No.:	1-2
		Report Number:	18C 0868 (Lot 104)
		Date Drilled:	26/10/18
Project:	Lot 104, Discover Marong Stage 4, Marong	Logged By:	TP
		Drilling Method	AS

Profile (mm):	* Structure: (see key)	Material Description:	Moisture Description:	Cohesion Density:	Plasticity:	Testing / Sampling:
0 To 100	Fill	BH1 Gravelly Sandy CLAY Dark brown, fine to medium sand, fine to medium gravel	D	St	Medium - Low	
100 To 1800		Soil profile	Silty CLAY Pale brown/brown, trace fine gravel	M	VSt	High
1800 To 2700	Silty CLAY Brown, some fine to coarse sand, some fine to medium gravel		M	VSt	Medium	
2700 To 3000	Silty CLAY Pale brown/grey		M	VSt	High	
0 To 100	Fill	BH2 Gravelly Sandy CLAY Dark brown, fine to medium sand, fine to medium gravel	D	St	Medium - Low	
100 To 1500		Soil profile	Silty CLAY Pale brown/brown, trace fine gravel	M	VSt	High

Key:

Drilling Method:	Moisture Condition	Cohesion:	Density:	Testing/Sampling:
AS - Auger Screwing	D - Dry	VS - Very Soft	VL - Very Loose	PP – Pocket Penetrometer
HA - Hand Auger	M - Moist	S - Soft	L - Loose	V – Hand Vane Sheer
	W - Wet	F - Firm	MD - Medium Dense	DCP – Dynamic Cone Penetrometer
		ST - Stiff	D - Dense	SPT – Standard Penetration Test
		VST - Very Stiff	VD - Very Dense	US – Undisturbed Sampling
		H - Hard		DS – Disturbed Sampling
		VH – Very hard		* See notes on borelog location page

MERRION STREET

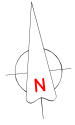

LOT 104

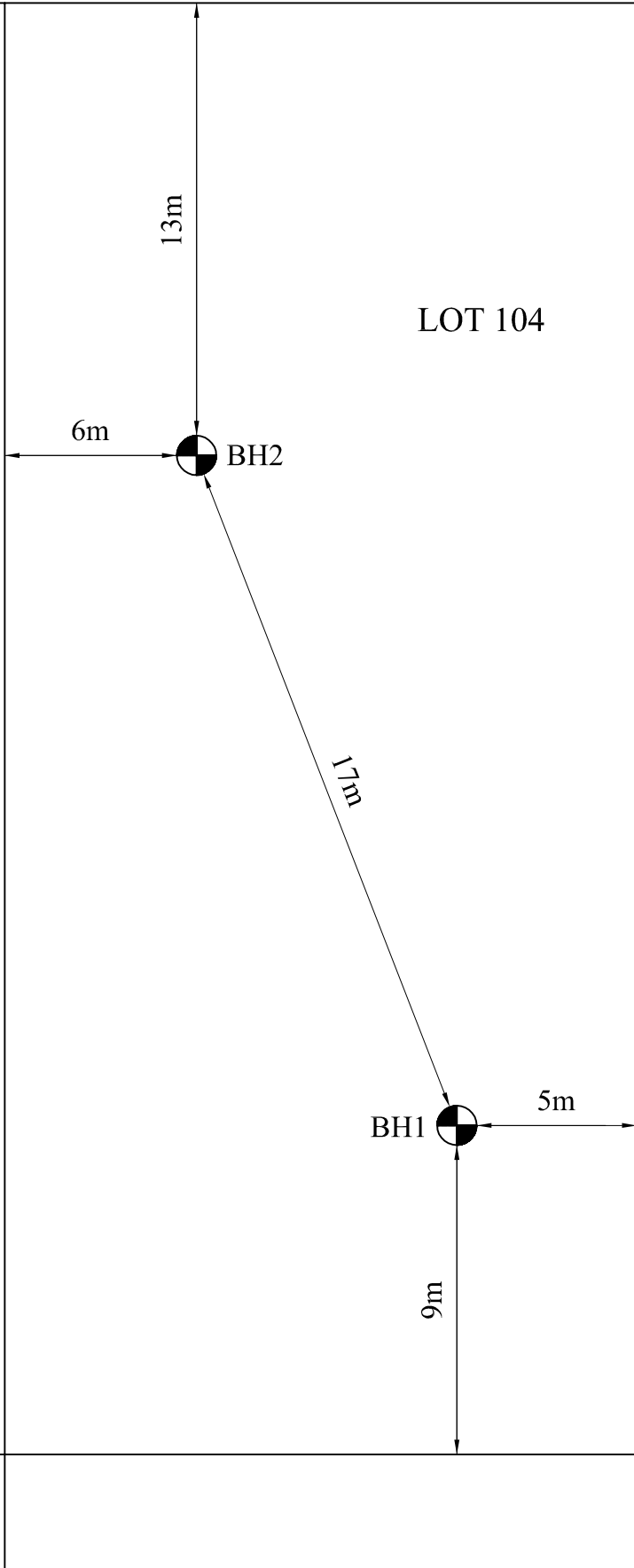

GEOTECHNICAL INVESTIGATION

APPROXIMATE LOCATIONS
NOT TO SCALE

CLIENT: ARBOR ESTATES
PROJECT: LOT 104, DISCOVER MARONG,
STAGE 4, MARONG

GTS REF: 18C 0868 LOT 104

DATE: 6 NOVEMBER 2018