



GEOTECHNICAL
TESTING SERVICES
SOUTHERN

SITE CLASSIFICATION

Client: Arbor Estates Pty Ltd
24 Jewell Court
East Bendigo, Vic 3550

Date: 19 August 2015

Project: Lot 10 Lancaster Drive, Canterbury Estate

1 INTRODUCTION

Arbor Estates commissioned Geotechnical Testing Services to conduct a geotechnical investigation for the proposed residential development located at Lot 10 Lancaster Drive, Canterbury Estate.

The investigation has been conducted for the purpose of assessing general subsurface conditions at the site and consequently assigning a Site Classification in accordance with AS2870 – 2011 “Residential Slabs and Footings”.

2 INVESTIGATION

The investigation was conducted by a technician on the 6th of August, 2015 using a vehicle mounted drill-rig and drilling 2 boreholes to depths of 1.5 metres within the designated area. The subsequent soil profiles are presented in page 4 and the location of the boreholes are presented on page 5.

At the time of this investigation, the type of development proposed is unknown to GTS.

3 SITE CONDITIONS

The site has a slight fall to the northeast and is currently vacant. At the time of the investigation the surface of the site was moist with no grass cover. There are no trees present in the immediate vicinity. There was no visual evidence of surface cracking.

Groundwater seepage was not encountered over the investigated depths and based on the site location and subsurface profile is highly unlikely to be within 3 metres of the surface at any time.

Full details of soil conditions are presented in the borehole logs.



GEOTECHNICAL
TESTING SERVICES
SOUTHERN

4 SITE CLASSIFICATION

After allowing due consideration to the site geology, soil conditions, nearby trees, drainage and known details of the proposed structure, the site has been classified as **Class S** (AS2870 – 2011).

Foundations designed in accordance with this classification are to be subject to the overriding conditions of Section 5 below.

5 DISCUSSION

Particular attention should be paid to the design of footings as required by AS2870 – 2011.

In addition to the normal founding requirements arising from the above classification, particular conditions at the site dictate that the founding medium and minimum depth below existing surface levels for all footings should be as follows:

- Silty CLAY, medium plasticity, orange/brown, very stiff
At depths below 0.1 metres

An allowable bearing pressure of 100kPa is available for edge beams, strips and stump footings founded as above. All foundations should extend a minimum of 100mm into the above founding material.

6 IMPORTANT NOTES ABOUT THIS REPORT

- The site classification presented in Section 4 assumes that the current natural drainage and infiltration conditions at the site will not be markedly affected by the proposed site development work. Care should therefore be taken to ensure that surface water is not permitted to collect adjacent to the structure and that significant changes to seasonal soil moisture equilibria do not develop as a result of service trench construction or tree root action.
- Attention is drawn to Appendix B of AS 2870 and CSIRO document, BTF 18 – “Foundation Maintenance and Footing Performance: A Homeowner’s Guide” as a guide to maintenance requirement for the proposed structure.
- This is not a comprehensive investigation nor is it economic or practical to determine every subsurface feature on the site. Although this investigation indicates that soil conditions are relatively



GEOTECHNICAL
TESTING SERVICES
SOUTHERN

uniform across the site, it is recommended that the base of all footing excavations be inspected to ensure that the founding medium meets that requirements referenced herein with respect to type and strength of founding materials. If further variations in descriptions in soil types, colour or depths are discovered during construction, this office should be notified immediately so that potential influence on the footings may be assessed.

- The soil colours provided in the borelogs attached may vary with soil moisture content and individual interpretation, therefore colour alone should not be used to identify these soils.
- Strength characteristics of soils often exhibit a large variation between wet and dry conditions. Soil characteristics of a soil profile are given on the soil conditions at the time of the investigation.
- In the event of significant earthworks being undertaken on the site after this investigation, this report may require an amendment if appropriate.
- If FILL is found during this investigation, it is an indication of what was found during the investigation and it may vary over the site. It may be in the best interest of the buyer / seller to undertake a more detailed investigation, in this instance.

Should you have any further queries concerning these results, please do not hesitate in contacting this office on 5441 4881

Yours faithfully

Shane Hampton BE (Hons)
Senior Geotechnical Engineer

Enclosed

Borelogs (Page 4)

Brief Site Map (Page 5)



GEOTECHNICAL
TESTING SERVICES
SOUTHERN

Borehole Logs

| | | | |
|----------|---|-------------------|----------|
| Client: | Arbor Estates | Borehole Log No.: | 1 - 2 |
| | | Report Number: | 15C 0668 |
| | | Date Drilled: | 6/8/15 |
| Project: | Lot 10 Lancaster Drive, Canterbury Estate | Logged By: | ML |
| | | Drilling Method | AS |

| Profile (mm): | * Structure: (see key) | Material Description: | Moisture Description: | Cohesion Density: | Plasticity: | Testing / Sampling: |
|--------------------------|------------------------|--|-----------------------|-------------------|-------------|---------------------|
| 0 to 100 to 700 To 1500 | Fill | BH1 Sandy SILT Brown | M/D | S | - | |
| | Soil Profile | Silty CLAY Orange/brown | M | VST | Medium | |
| | Rock | SILTSTONE, Extremely weathered, white, red | D | Moderate | | |
| 0 to 100 to 1000 to 1500 | Fill | BH2 Sandy SILT Brown | M/D | S | - | |
| | Soil Profile | Silty CLAY Orange/brown, some siltstone seams | M | VST | Medium | |
| | Rock | SILTSTONE, Extremely weathered, white, red | M | Moderate | | |

Key:

| Drilling Method: | Moisture Condition | Cohesion: | Density: | Testing/Sampling: |
|---------------------|--------------------|------------------|-------------------|--------------------------------------|
| AS - Auger Screwing | D - Dry | VS - Very Soft | VL - Very Loose | PP – Pocket Penetrometer |
| HA - Hand Auger | M - Moist | S - Soft | L - Loose | V – Hand Vane Sheer |
| | W - Wet | F - Firm | MD - Medium Dense | DCP – Dynamic Cone Penetrometer |
| | | ST - Stiff | D - Dense | SPT – Standard Penetration Test |
| | | VST - Very Stiff | VD - Very Dense | US – Undisturbed Sampling |
| | | H - Hard | | DS – Disturbed Sampling |
| | | VH – Very hard | | * See notes on borelog location page |



Borehole Locations

| | |
|----------|---|
| Client : | ARBOR ESTATES |
| Project: | LOT 10 LANCASTER DRIVE CANTERBURY ESTATE |

| | |
|------------------|----------|
| Borehole No. : | 1 - 2 |
| Report No. : | 15C 0668 |
| Date Drilled : | 6/8/15 |
| Operator: | ML |
| Drilling Method: | A.S |
| Page No.: | 5 of 5 |

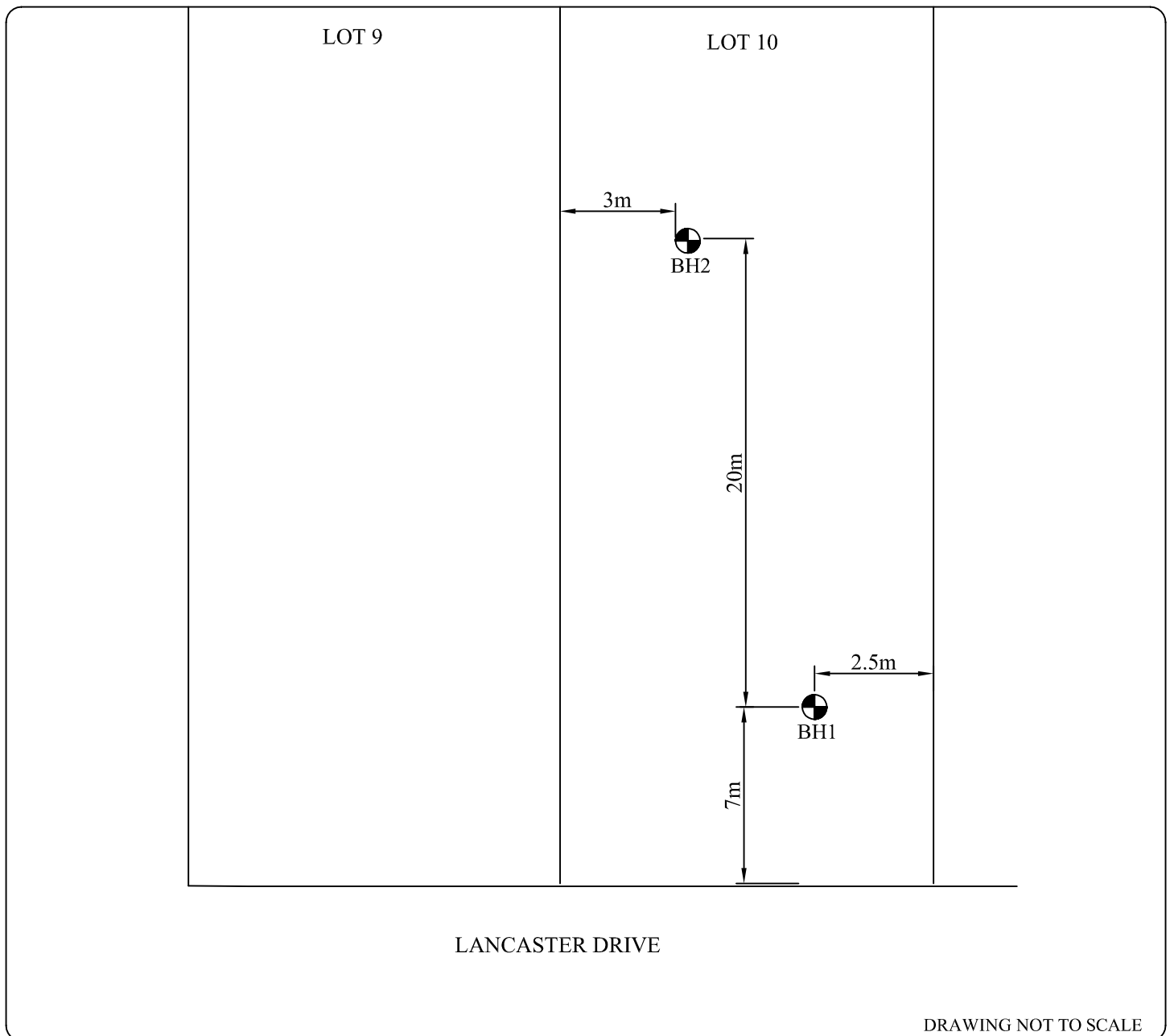

DRAWING NOT TO SCALE

(T) = TREES